



Plot # 49,
Margalla Facing Sector C-1,
Service Road South Bahria Enclave,
Islamabad.



/@maheenarcade



/maheenarcade



www.maheenarcade.com



info@maheenarcade.com



+92 308 88 33 500
+92 321 47 9695 3



M A H E E N A R C A D E

UAN: 111 500 400

www.maheenarcade.com



The infrastructure of Maheen Arcade stands as a testament to modern convenience and comfort.

From robust structural integrity to state-of-the-art amenities, every aspect is meticulously designed to enhance residents' lifestyles. High-speed elevators whisk occupants effortlessly to their floors, while smart technology seamlessly integrates security and energy efficiency.

Thoughtful attention to detail is evident in the sleek, contemporary design, complemented by spacious parking, well-lit corridors, and lush communal spaces.

With a focus on safety, accessibility, and sustainability, our infrastructure provides a solid foundation for residents to thrive and enjoy urban living at its finest.

Experience the future today in our forward-thinking building, where smart technology seamlessly integrates into every aspect of daily life. From voice-controlled amenities to virtual reality entertainment, our futuristic lifestyle redefines urban living for the modern age.

Welcome to tomorrow, where convenience, efficiency, and sustainability converge in every corner of your home.

RESIDENTIAL
APARTMENTS

CORPORATE
OFFICES

COMMERCIAL
SHOPS

Smart
AUTOMATED BUILDING

PENTHOUSE

SMART
APARTMENTS

CORPORATE
OFFICES

COMMERCIAL
SHOPS



BAHRIA ENCLAVE

Bahria Enclave Islamabad is a prestigious housing project by Bahria Town, Private Limited, featuring residential plots ranging from 5 marla to 2 Kanal and commercial plots of 4 and 8 marlas. The project, situated around 8 km from Chak Shahzad, boasts rapid construction progress and amenities including schools, mosques, hospitals, a commercial mall, restaurants, parks, and a zoo. Its features encompass a 5-star hotel, restaurants, parks, a cinema, and international standard educational and healthcare facilities.

With approved layout plans by the Capital Development Authority, Bahria Enclave offers a gated community with underground utilities, 24-hour security, and lush green landscapes. Additionally, it provides prime commercial areas, ensuring a thriving business environment with excellent infrastructure and connectivity, making it an ideal destination for both living and investing. Enjoying picturesque views of the Margalla Hills and just 20 minutes away from Islamabad, it offers a serene living environment with a variety of housing options catering to diverse needs.

LOCATION

The project is the ideal location to refresh, connect and come alive. The establishment of building is envisioned and designed to offer breathtaking views of Islamabad, with a high demand for living & business spaces that offer prime convenience, the location of Maheen Arcade is ideal for residents of the twin cities. It has renowned international and local food eateries in its vicinity, and also lies within close distance to pharmacies and convenience outlets to make your life as comfortable as possible.

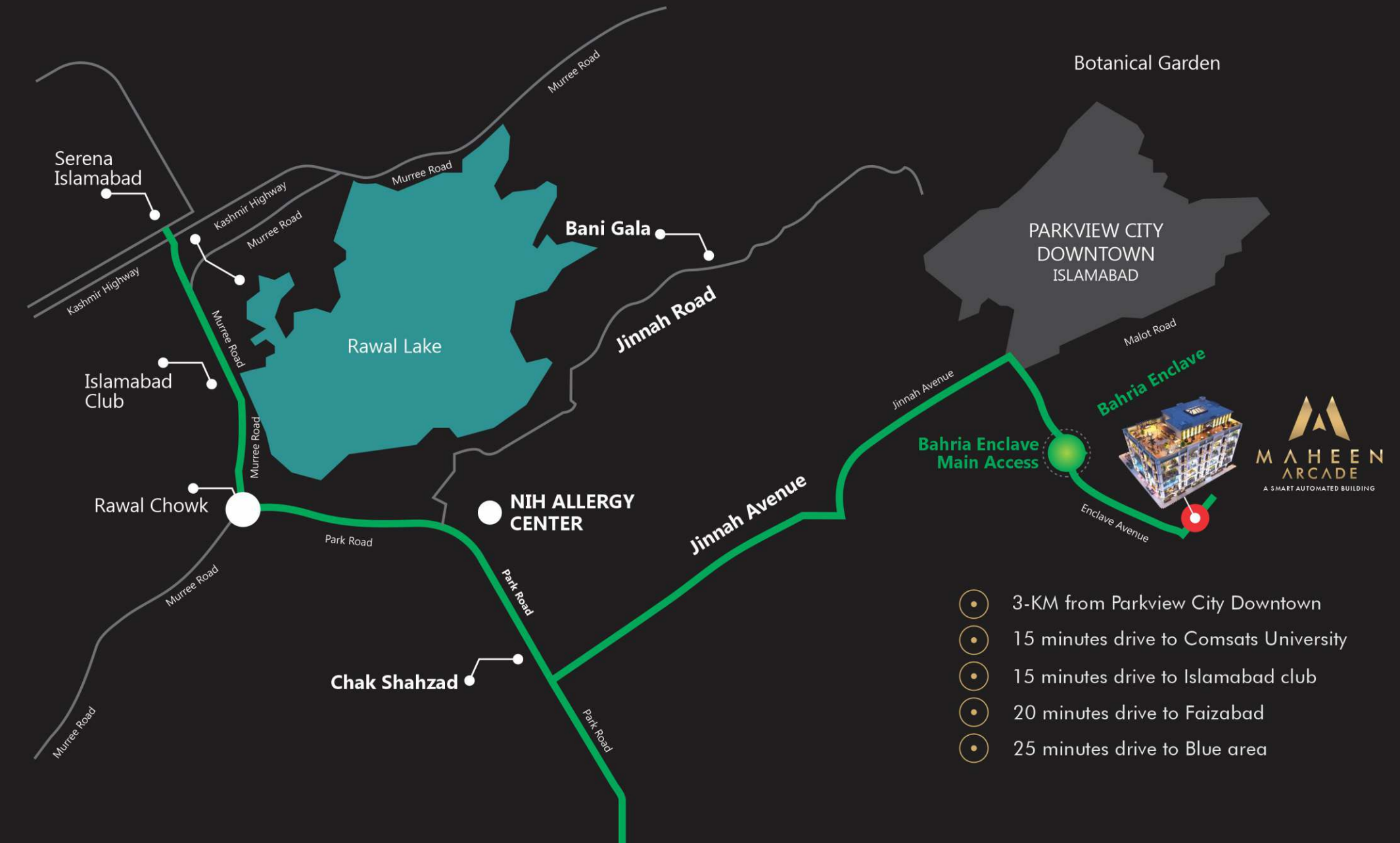

ISLAMABAD

Nestled against the picturesque Margalla Hills, Islamabad offers a unique blend of natural beauty and urban sophistication. Its well-planned infrastructure, lush greenery, and vibrant cultural scene create a harmonious environment where the pace of life is both vibrant and tranquil. As the capital city of Pakistan, Islamabad embodies progress and innovation, providing residents with endless opportunities for growth, education, and employment. From iconic landmarks like Faisal Mosque to bustling markets and culinary delights, the city captivates with its rich history, culture, and diversity. Clean and safe neighborhoods, excellent healthcare facilities, and top-notch educational institutions contribute to a high quality of life for families and individuals.

Whether exploring pristine parks, vibrant festivals, or welcoming communities, living in Islamabad is an enriching experience that seamlessly balances tradition with modernity, making every day a celebration of unity, progress, and resilience. "In Islamabad, every day is an opportunity to explore, learn, and thrive in a city that embodies the spirit of unity, progress, and resilience.

2nd Most Beautiful
Capital City in the
World

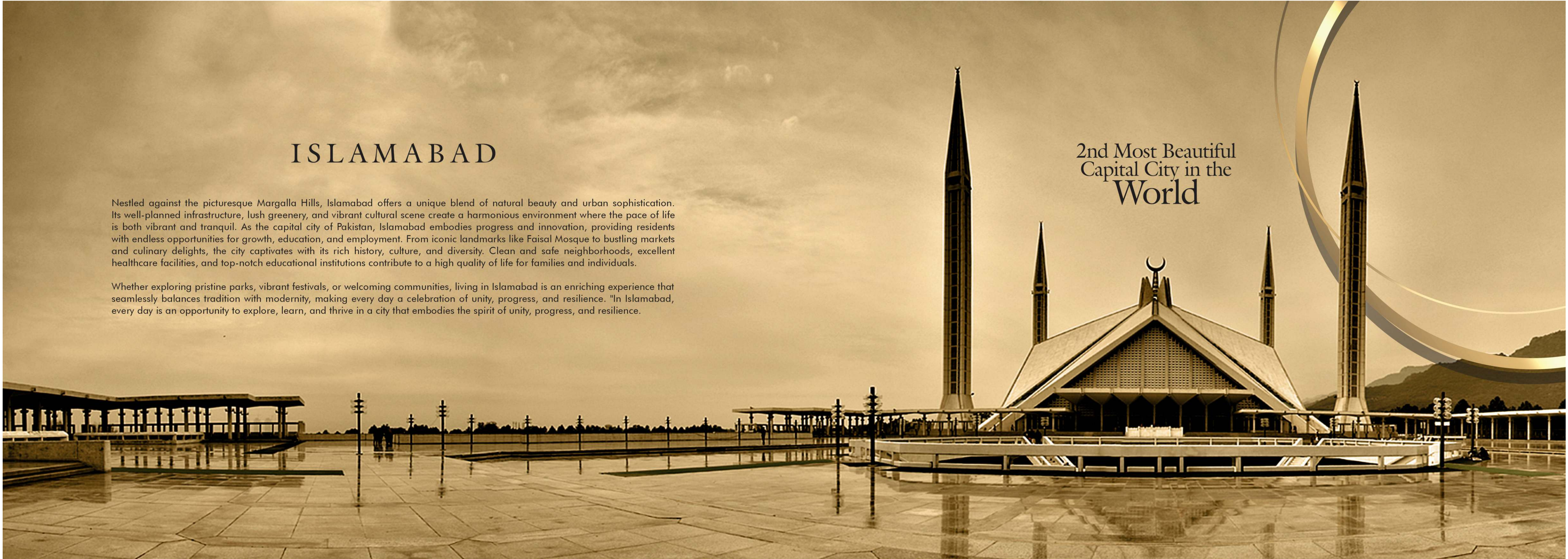

^aSmart AUTOMATED BUILDING

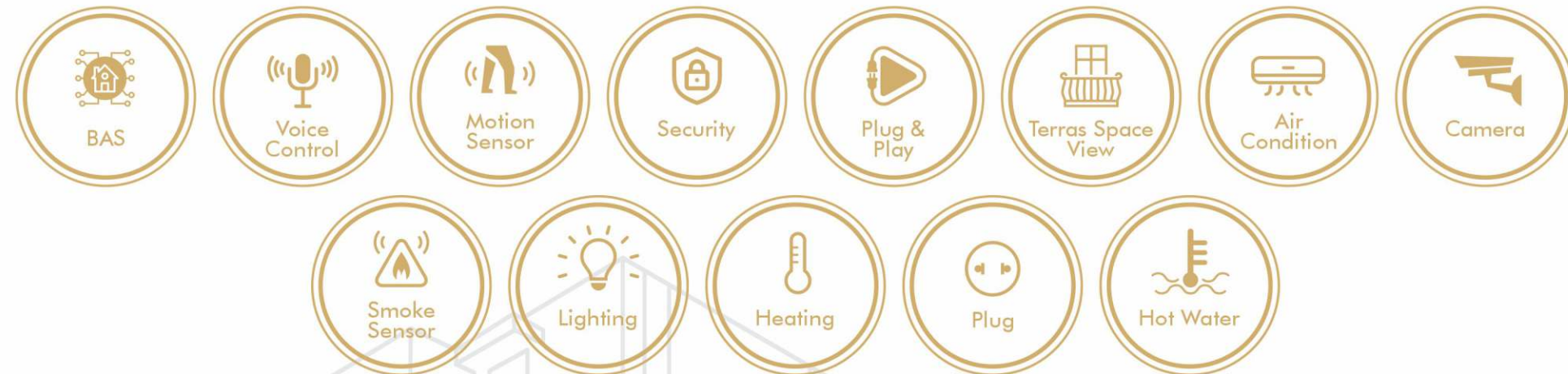

At Maheen Arcade, we prioritize convenience and efficiency with our cutting-edge Building Automation System (BAS).

Seamlessly integrated throughout the building, our BAS optimizes energy usage, enhances security, and elevates the overall living experience for our residents. With intuitive controls accessible via smartphone or tablet, residents can effortlessly manage lighting, temperature, and security systems with a touch of a button.

Enjoy the comfort of personalized settings that adjust to your preferences, creating the perfect ambiance for every occasion. Our BAS also enhances safety and security, with features such as surveillance cameras, access control, and automated alerts ensuring peace of mind for all occupants.

At Maheen Arcade, our Building Automation System brings a new level of convenience, comfort, and security to modern living.



COMMERCIAL AREA

Welcome to our vibrant commercial area,

Where every visit is an adventure filled with endless possibilities. Immerse yourself in urban charm as you explore diverse shops, eateries, and opportunities for connection and collaboration. Experience convenience, support local businesses, and become a part of our thriving community today.

Make a lasting impression with our exterior design expertise. Our team crafts captivating facades that draw attention and reflect your brand's identity. Whether it's a vibrant storefront or a welcoming entrance, we turn visions into striking realities."





EXPERIENCE
THE CONVENIENCE
OF HAVING EVERYTHING
YOU NEED RIGHT AT
YOUR DOORSTEP AT
MAHEEN ARCADE



COMMERCIAL SHOPS

Welcome to **Maheen Arcade,**

Where shopping meets convenience in the heart of the city. Our collection of shops within the building offers a diverse range of retail experiences, catering to every need and desire. Whether you're seeking the latest fashion trends, indulging in gourmet delicacies, or searching for everyday essentials, our meticulously curated selection of shops has something for everyone.

With modern amenities and a vibrant atmosphere, Maheen Arcade is more than just a shopping destination - it's a hub of community and commerce, where locals and visitors alike come together to explore, discover, and indulge.

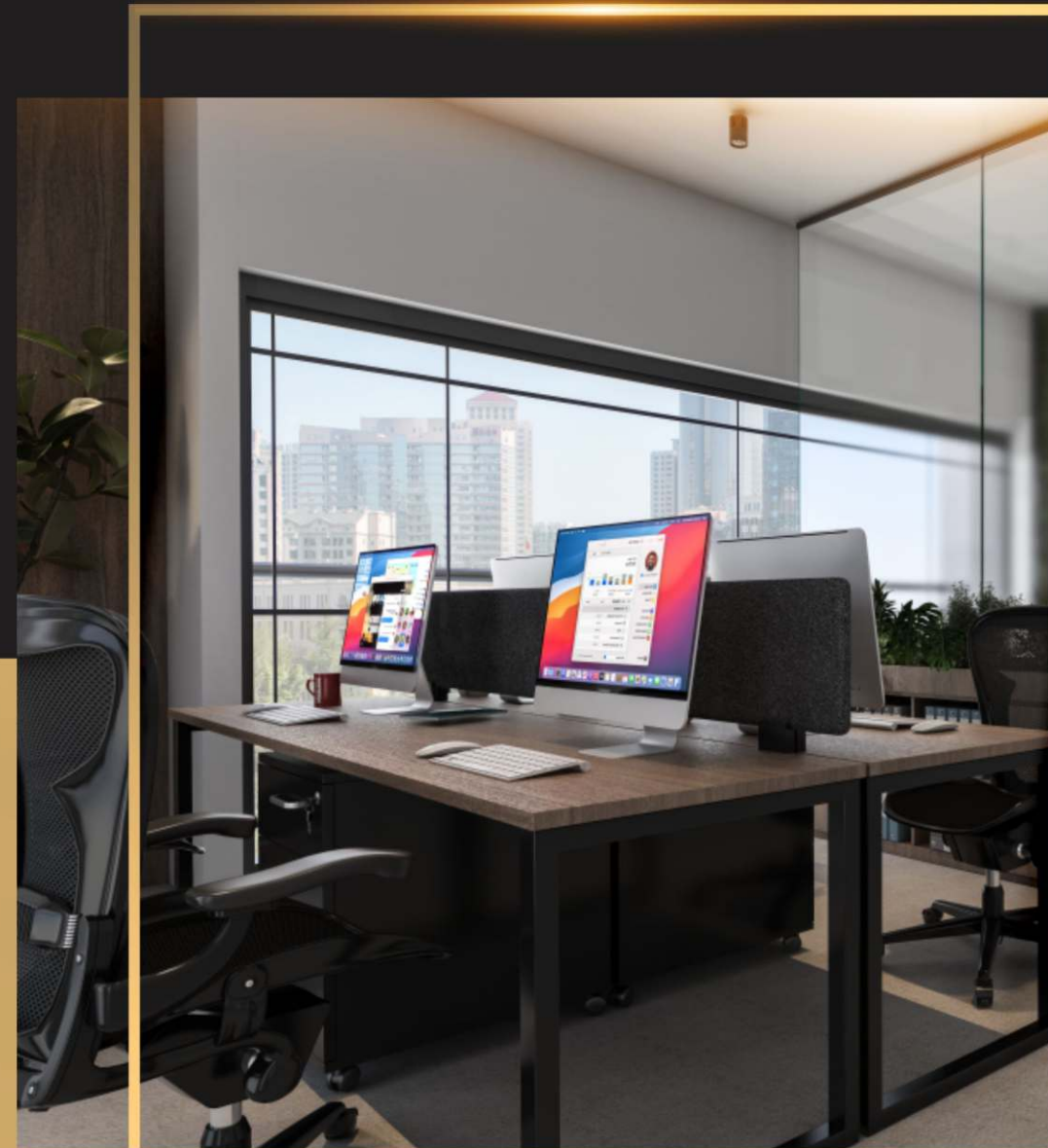

CORPORATE OFFICES

WELCOME TO THE EPITOME OF
CORPORATE EXCELLENCE AT
MAHEEN ARCADE



Our state-of-the-art corporate offices redefine the standards of professional workspace, offering a blend of sophistication, functionality, and efficiency. Designed to inspire innovation and collaboration, each office space is equipped with modern amenities and cutting-edge technology to support the dynamic needs of businesses in today's fast-paced world. With flexible layouts, ample natural light, and ergonomic furnishings, our offices provide a conducive environment for productivity and success.





















Whether you're a startup looking to make your mark or an established corporation seeking a address, Maheen Arcade offers the ideal setting for your business to thrive. Elevate your corporate presence and unlock your potential at Maheen Arcade's prestigious offices.

Modern Amenities

AWAIT

At Maheen Arcade, we pride ourselves on offering a comprehensive array of modern amenities designed to elevate your living experience to new heights. Our commitment to sustainability is evident with the inclusion of solar systems, ensuring eco-friendly energy solutions while reducing your carbon footprint. Experience unparalleled convenience with our high-speed lifts, providing swift and efficient access to all floors. Say goodbye to parking woes with our outdoor car parking facilities, providing ample space for residents and visitors alike.

Whether you're enjoying the convenience of our automated building systems or embracing the tranquility of our landscaped outdoor areas, Maheen Arcade is dedicated to providing you with a lifestyle of luxury, comfort, and sustainability.

 AUTOMATION	 SOLAR SYSTEM	 ENERGY EFFICIENT APPLIANCES	 HIGH SPEED LIFT	 24/7 BACKUP GENERATOR
 TOW WAYS ENTRANCE	 HIGH SPEED INTERNET	 CONSOLE GARBAGE SYSTEM	 24/7 CCTV SURVEILLANCE	 FIRE FIGHTING
 SHED PARKING	 IN HOUSE LAUNDRY	 YEARLY MAINTENANCE	 PRAYER AREA	 ON MAIN BOVD DESIGNED BUILDING
 BANKS	 PARKS	 GYM	 PLAY LAND	 JOGGING TRACKS



BOTH-SIDE WAY-IN

Experience seamless access to the first floor through our back side entryway. Surrounded by lush greenery and tranquil scenery, this entrance provides a private and picturesque pathway to your destination. Whether you're heading home or visiting our facilities, the back side entryway ensures a peaceful transition into Maheen Arcade.



Explore the Back Side Entryway





EMBRACING SPACE & ELEGANCE

Every Apartment and Duplex Reflects Our Signature Philosophy, Maximizing Light, Height, and Airflow.

Enjoy panoramic views through full-spectrum windows, ensuring natural ventilation and dust filtration even when shut. With elevated floor-to-ceiling heights, each residence exudes grandeur and spaciousness, harmonizing effortlessly with your prized possessions, cherished collectibles, and life's greatest achievements."

2Bed

FAMILY ORIENTED



1236.69 sq/ft

GROSS: 1,236.69

NET: 989.35

SERVICE: 247.34

Welcome to the Family Oriented two-bedroom apartment, where comfort and convenience converge in a spacious layout spanning 1237 square feet.

Designed with families in mind, this apartment offers ample space for everyone to relax and unwind. The master bedroom features luxurious amenities and a private en-suite bathroom, while the additional bedroom provides flexibility and comfort for family members or guests.

Gather in the open plan living and kitchen area, a welcoming space ideal for quality time together. Embrace the joys of family living with the Family Oriented apartment.

Create lasting memories together.

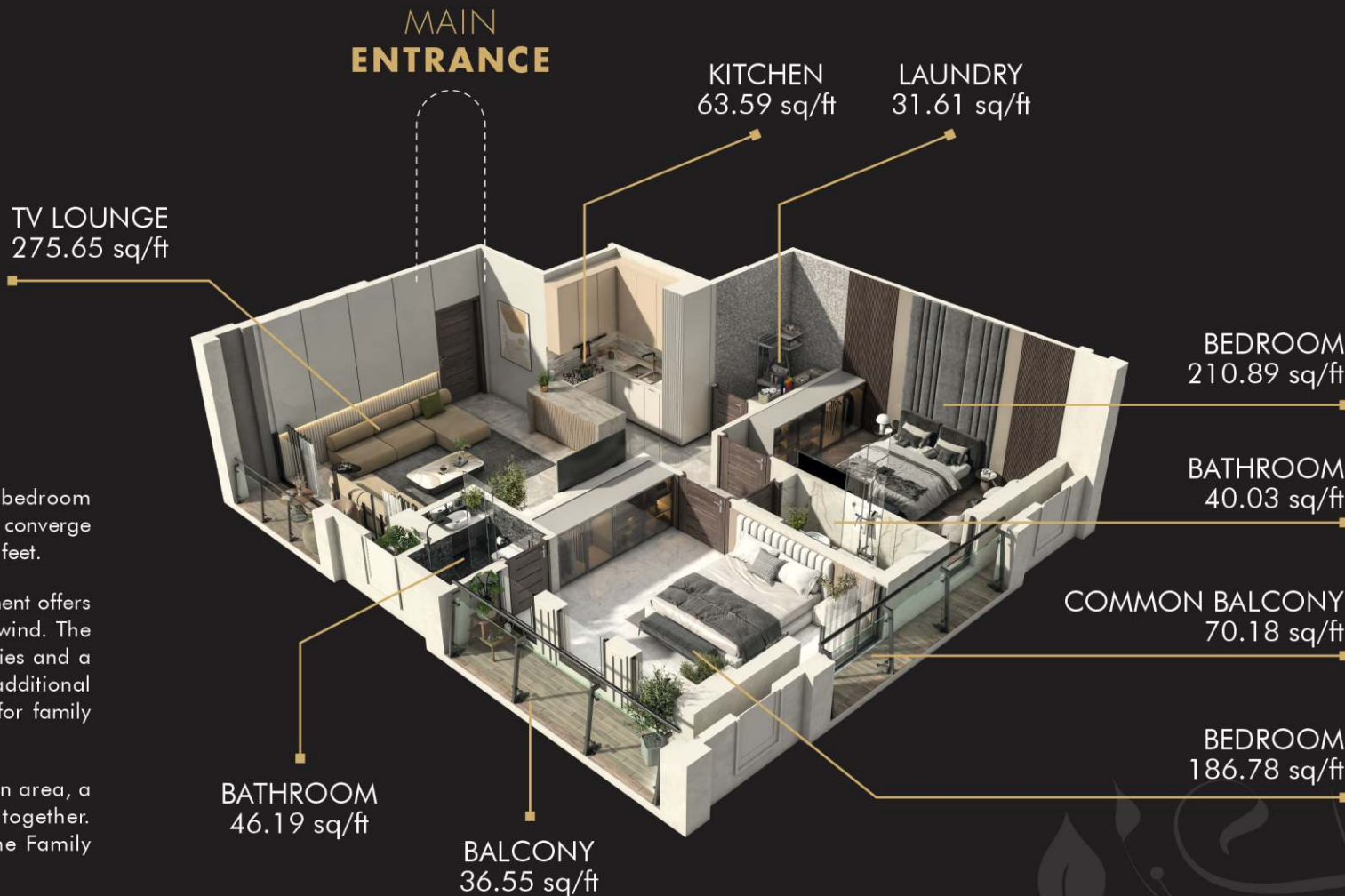

1Bed

PREMIUM



874.10 sq/ft

GROSS: 874.10

NET: 699.28

SERVICE: 174.82

Experience the epitome of sophistication in the Premium one-bedroom apartment, offering a spacious retreat spanning 874 square feet.

From the moment you enter, you'll be captivated by the luxurious ambiance and impeccable design.

The expansive bedroom invites relaxation with its deluxe amenities and elegantly appointed en-suite bathroom. Entertain in style or simply unwind in the open plan living and kitchen area, where comfort meets effortless elegance. Embrace a lifestyle of luxury and refinement with the Premium apartment.

Redefine your living experience



1 Bed

PLATINUM



815.36 sq/ft

GROSS: 815.36
NET: 652.29
SERVICE: 163.07

Elevate your lifestyle with the Platinum one-bedroom apartment, the pinnacle of modern luxury spanning 815.36 square feet. Experience unparalleled comfort and style as you step into this exquisitely crafted living space.

The generously sized bedroom boasts opulent features and an indulgent en-suite bathroom, offering a sanctuary of tranquility. Entertain guests or unwind in the chic open plan living and kitchen area, designed to inspire both intimacy and sophistication. Discover a world of elegance and sophistication with the Platinum apartment.

Discover luxury redefined

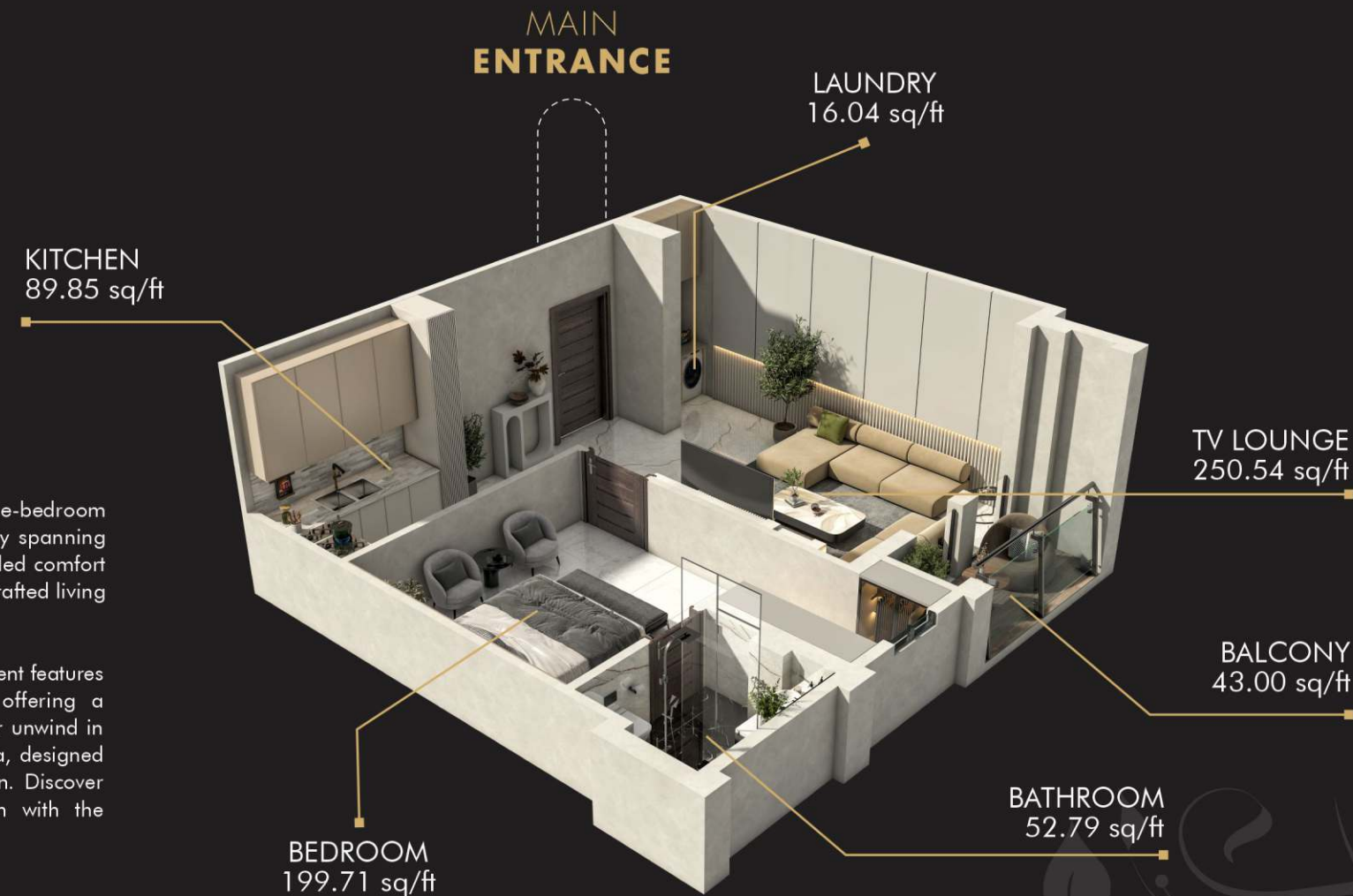

1 Bed

KINGSMAN



777.36 sq/ft

GROSS: 777.36
NET: 621.89
SERVICE: 155.47

Step into the regal elegance of the Kingsman, where luxury meets comfort in this meticulously designed one-bedroom apartment. With a spacious layout spanning 777.36 sq/ft, indulge in the serene ambiance and sophisticated aesthetics that define this living space.

The expansive bedroom beckons with its plush amenities, complemented by a lavishly appointed en-suite bathroom.

The open plan living and kitchen area exude a sense of grandeur, perfect for both relaxation and entertainment. Embark on a new chapter of opulence and refinement with the Kingsman apartment.

Experience regal living at its finest

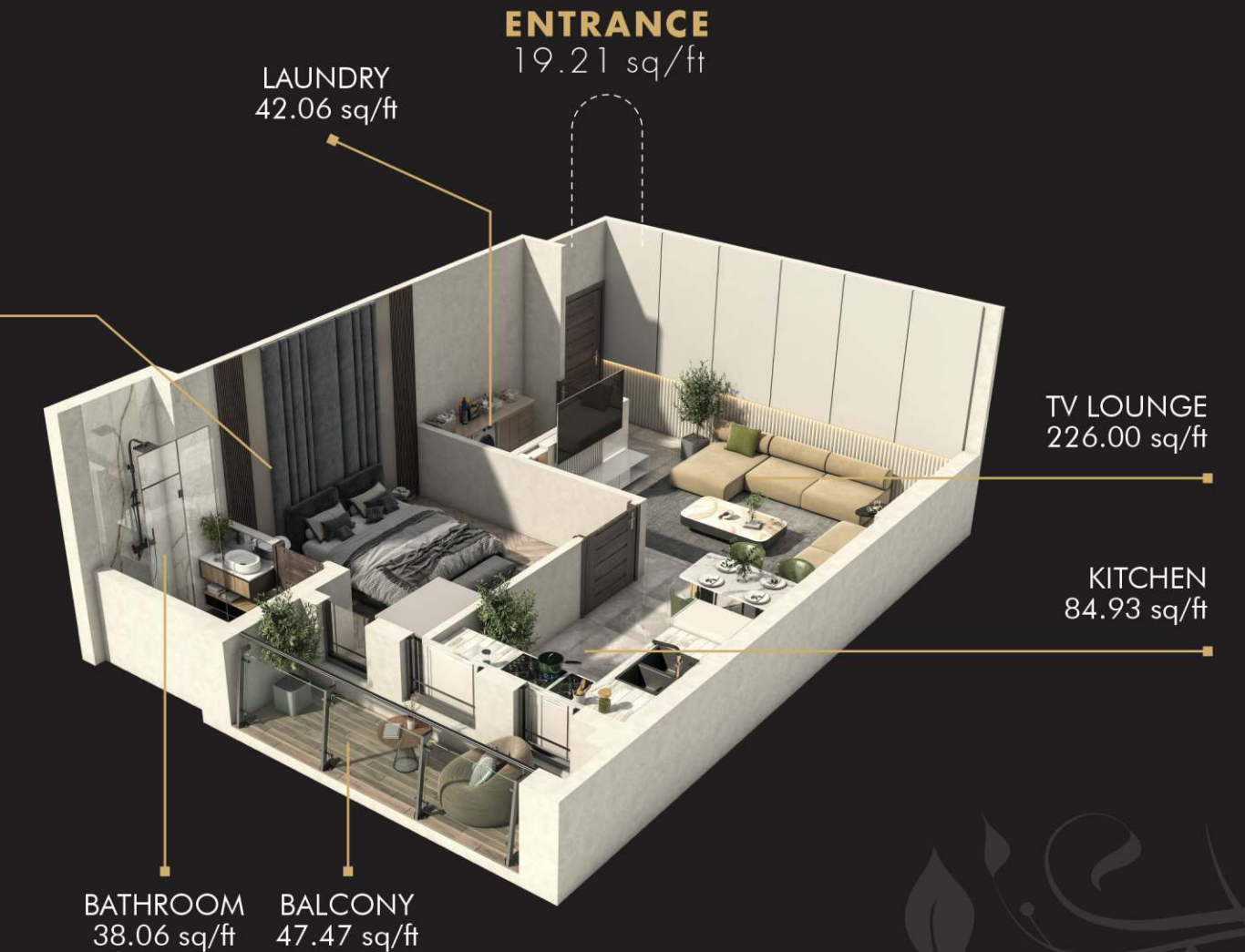

1 Bed OPEN HOUSE



571.50 sq/ft

GROSS: 571.50

NET: 457.20

SERVICE: 114.30

Maheen Arcade extraordinary One-Bedroom Open House Apartment is sensual, tactile and visually magnificent with a finished look. The layout is extremely spacious with one very large bedroom and luxuriously appointed en-suite bathroom.

There is also an open plan living and kitchen area to mesmerize your comfort. A one bedroom open house apartment starts from 571.50 sq/ft to ease your convenience of your budget and financial needs.

A new beginnings awaits you!



AL-SARWAR ARCADE
LUXURY ALL AROUND

KeyNext
MARKETING PVT. LTD.
SEARCH, SEE & SERVE

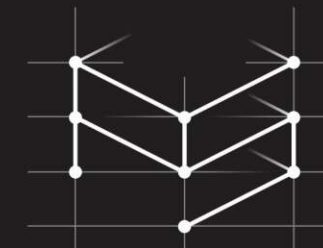

PS CONSTRUCTION
Build Future With Us!

AL-SARWAR ARCADE

Al-Sarwar Arcade is a captivating residential/commercial complex in the lovely Park View neighborhood of Islamabad that offers One, Two, and Three-bedroom homes as well as high-end commercial stores. Alsarwar Arcade is a building that was purposefully and skillfully constructed to meet all of the aesthetic and functional requirements. The exquisite earthquake-proof structure has purposeful interiors and exteriors.

KEYNEXT MARKETING PVT. LTD.

At Keynext Marketing Pvt. Ltd., our vision is to redefine the real estate experience by providing innovative solutions, exceptional service, and unmatched value to our clients. We strive to be the preferred choice for individuals and businesses seeking quality properties and investment opportunities.

PS CONSTRUCTION

Pioneer Sayein Construction Company (PSC) is Pakistan based construction firm providing full range of construction and engineering services to all form of organizations. PSC was established in 2009. It is being run by a team of professionals with relevant expertise and experience in all aspects of construction, designing and management. PSC is committed to serve its clients with the best available resources and dedicated team to ensure international level services.

PSC is a private construction set up render that Construction Services through implementation of different kind of projects to Government deparatmetns and private sector Consequently, PSC is a construction company which secures to get high level expertise in construction and materializing on the constructional projects about contracting and contract realizing, and construction planning.